

FRONT DOORS

RD65/ RD65N/ RD80/ RD100
Installation manual

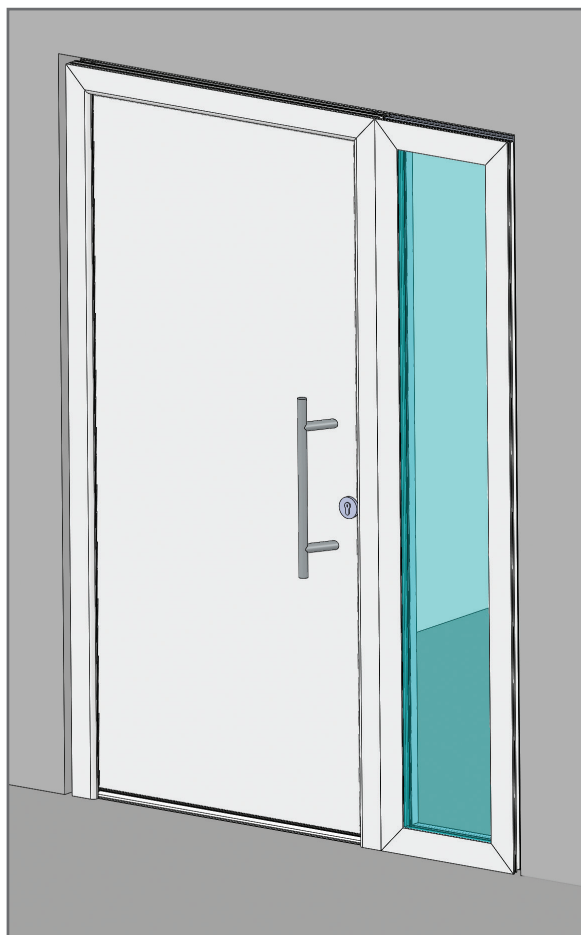

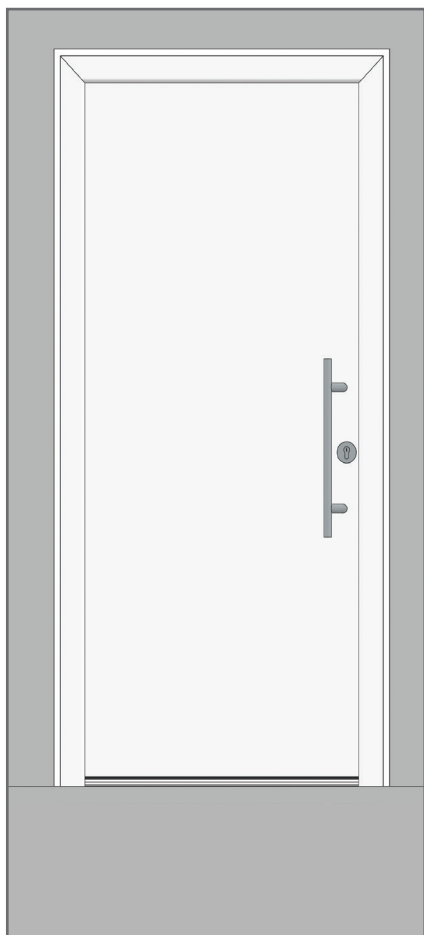

3 mm



4 mm

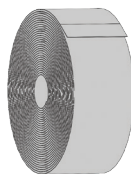

Ø 6 mm
Ø 4 mm

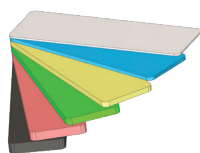

Torx T25



7.5x182mm
5.5x40-90mm

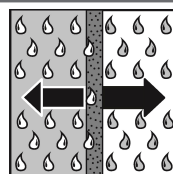
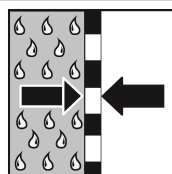
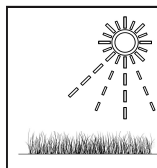
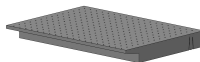

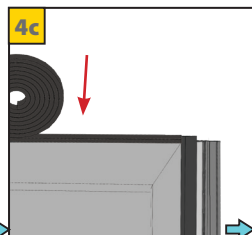
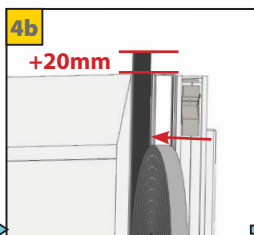
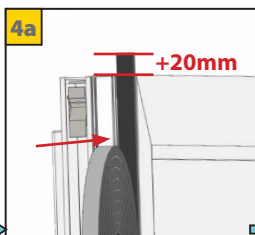
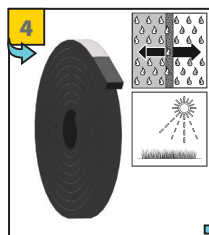
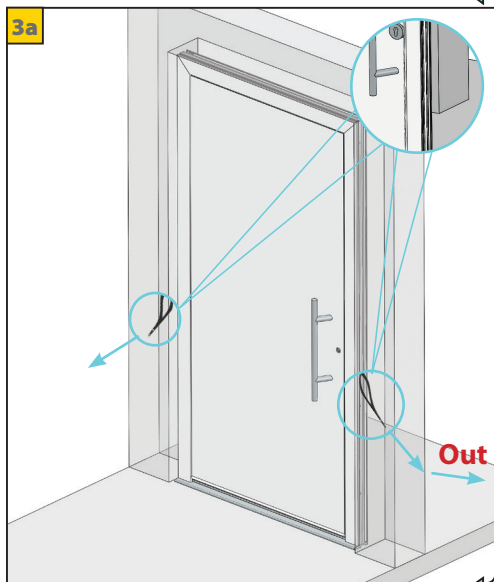
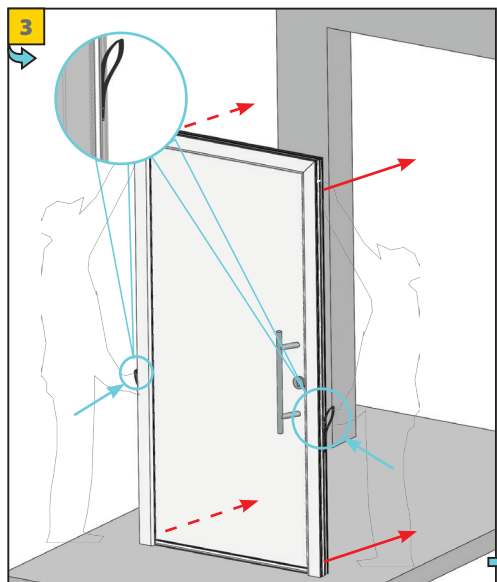
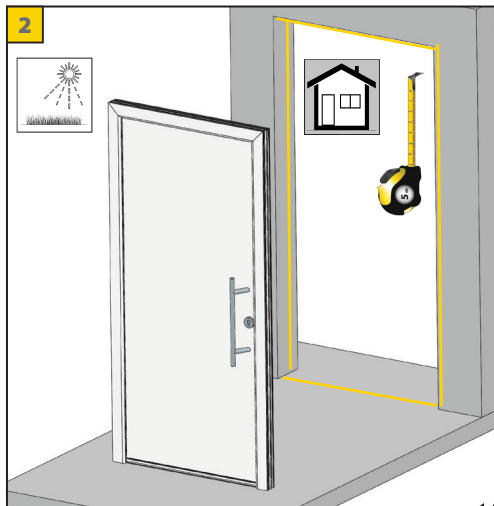
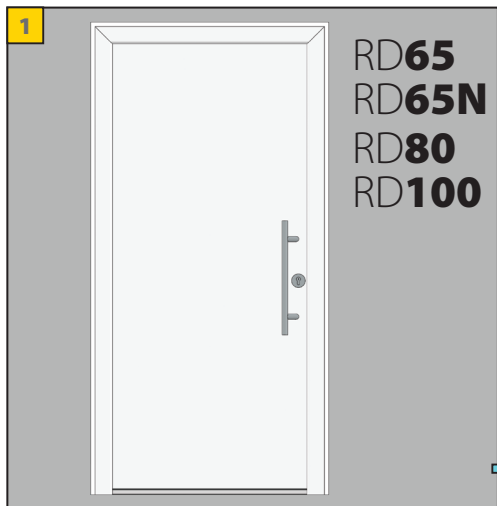

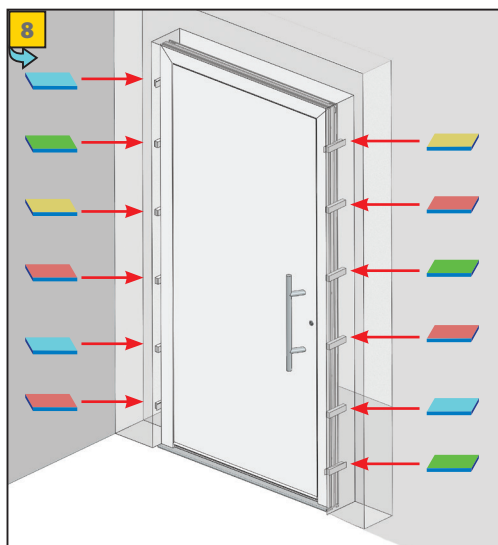
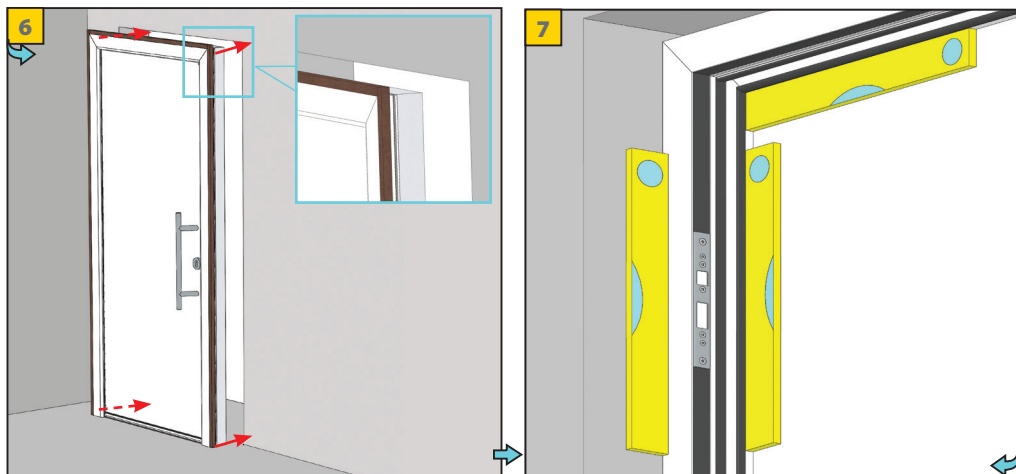
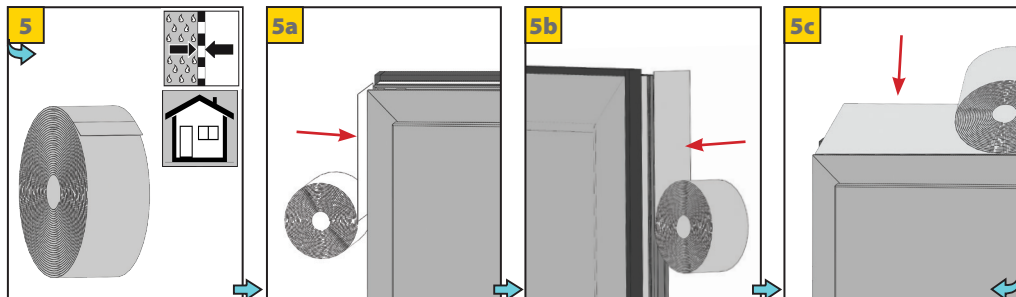

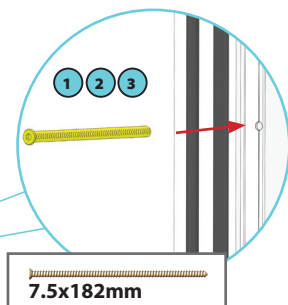
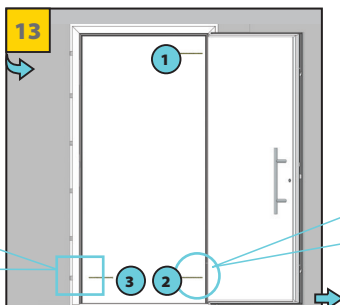
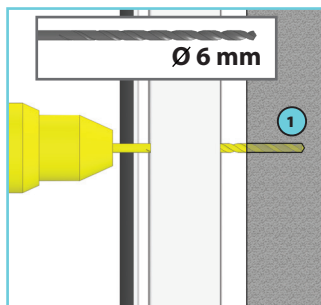
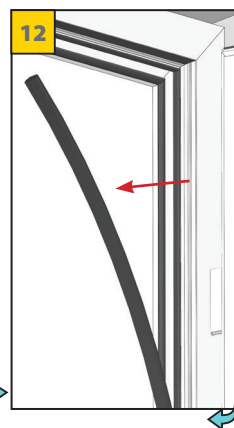
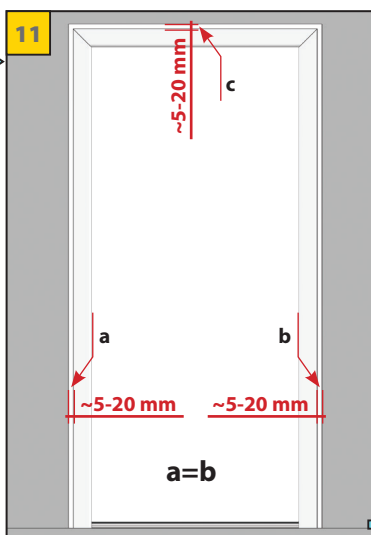
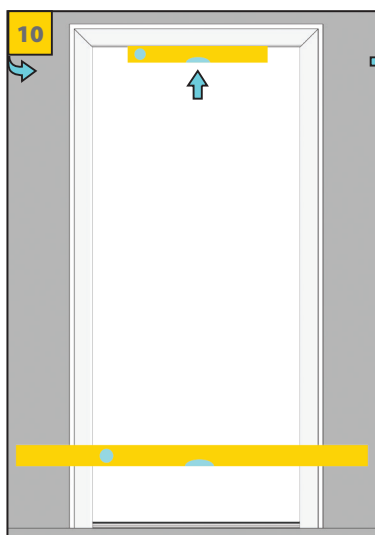
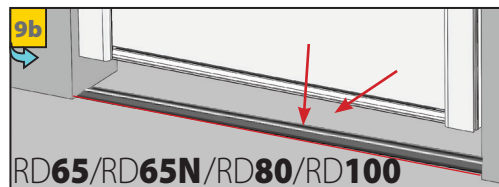
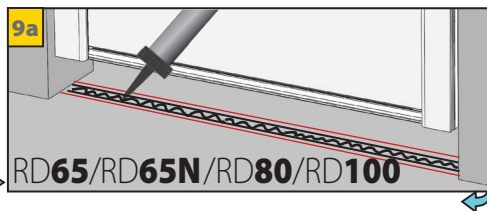
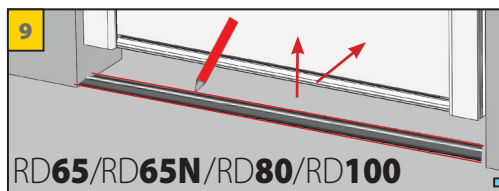

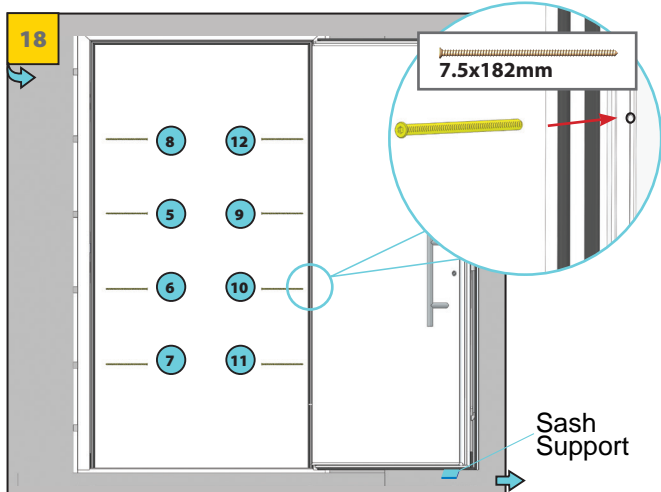
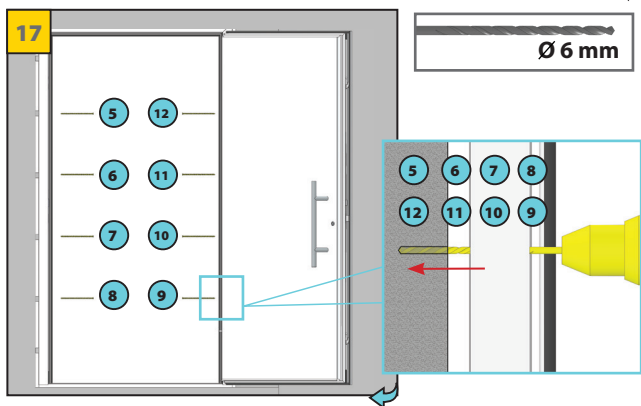
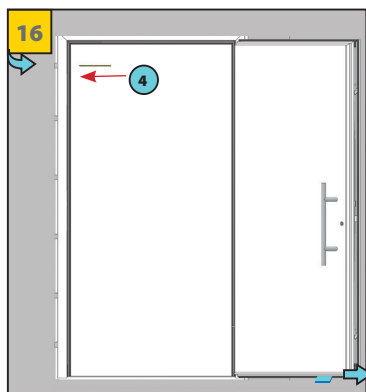
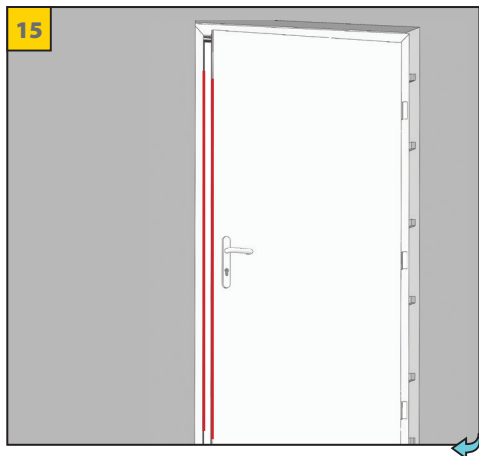
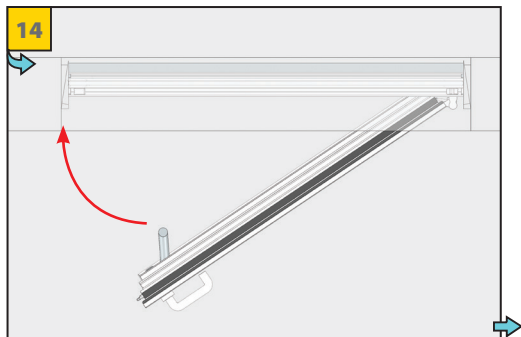

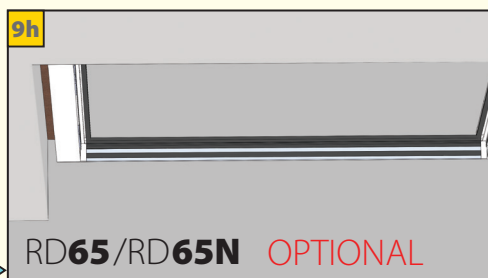
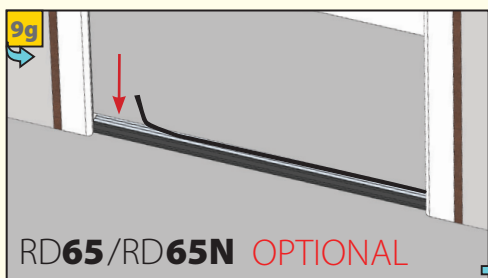
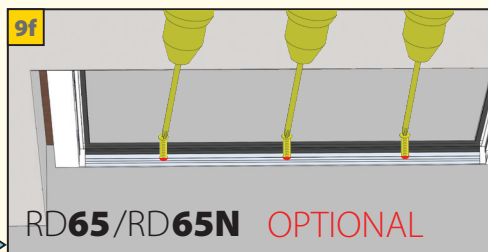
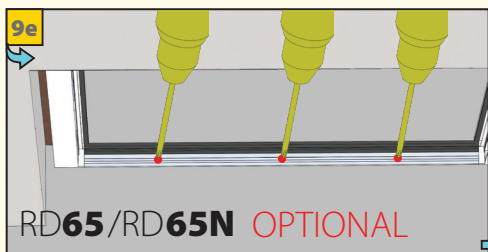
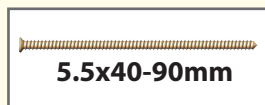
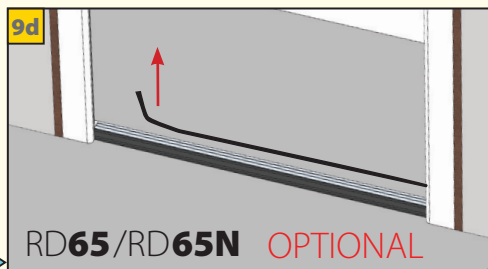
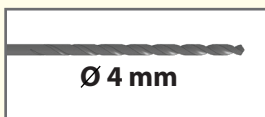
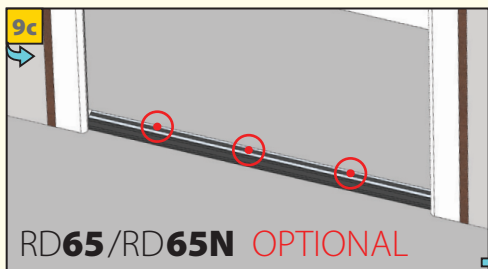

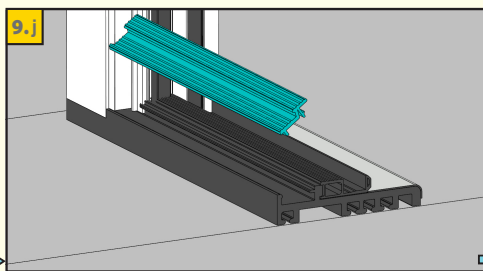
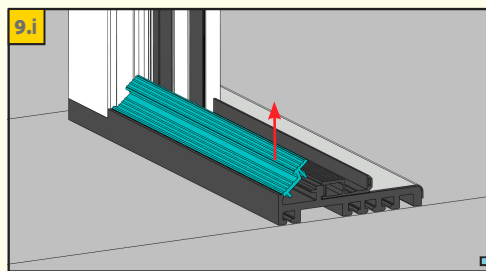
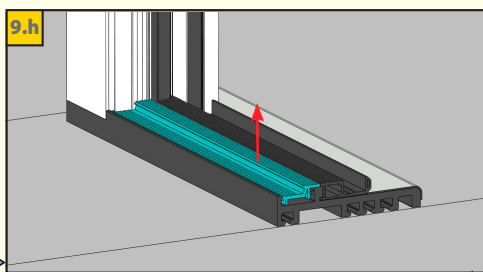
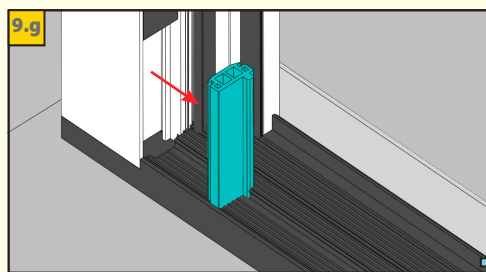
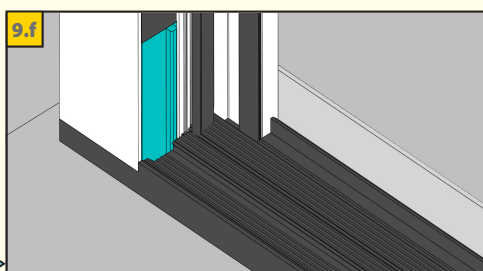
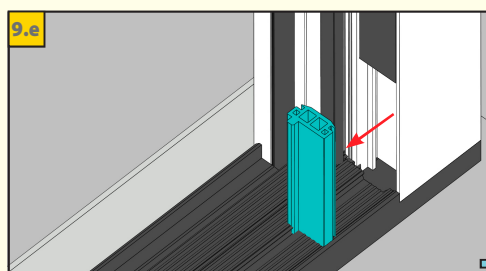
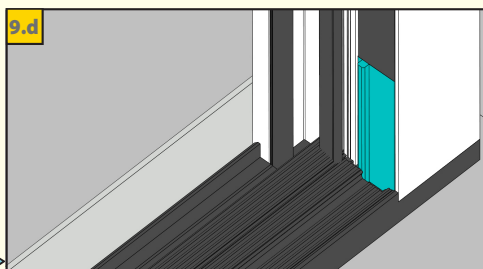
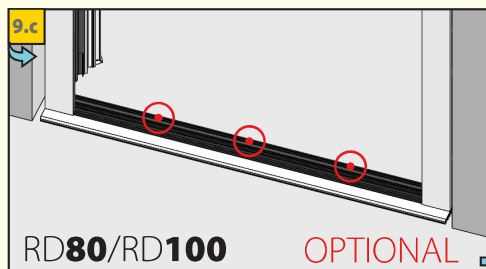

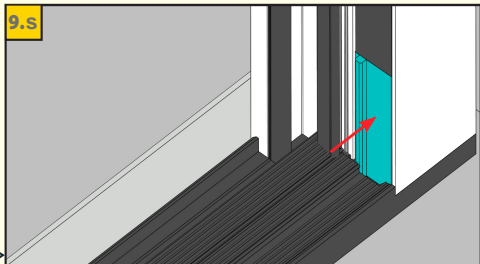
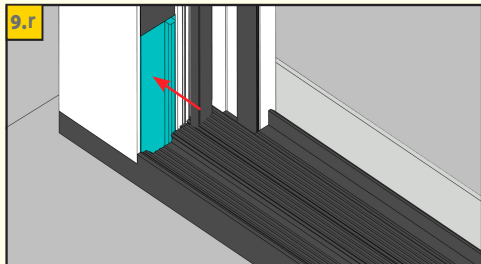
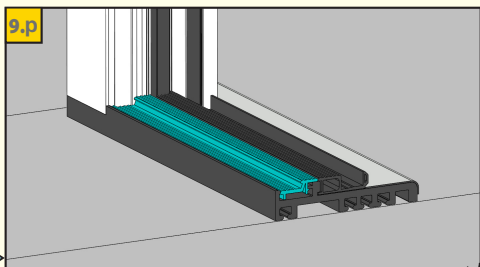
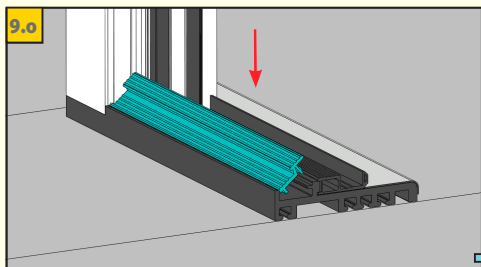
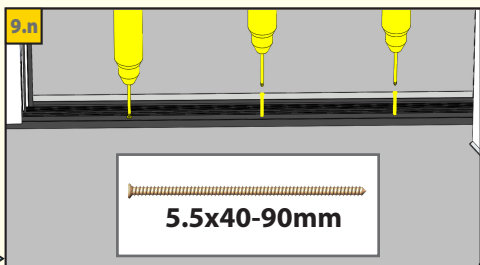
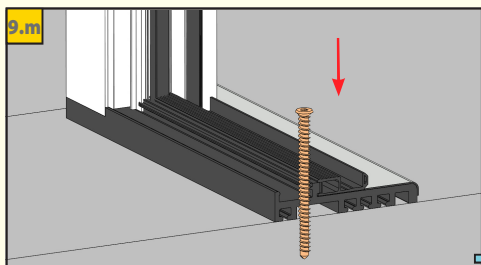
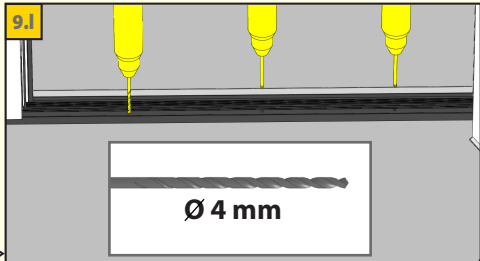
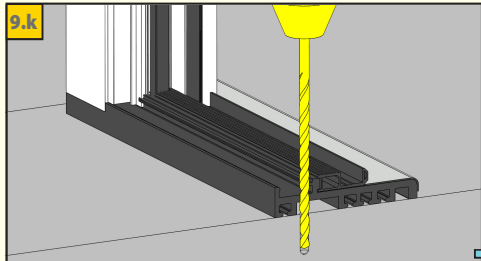

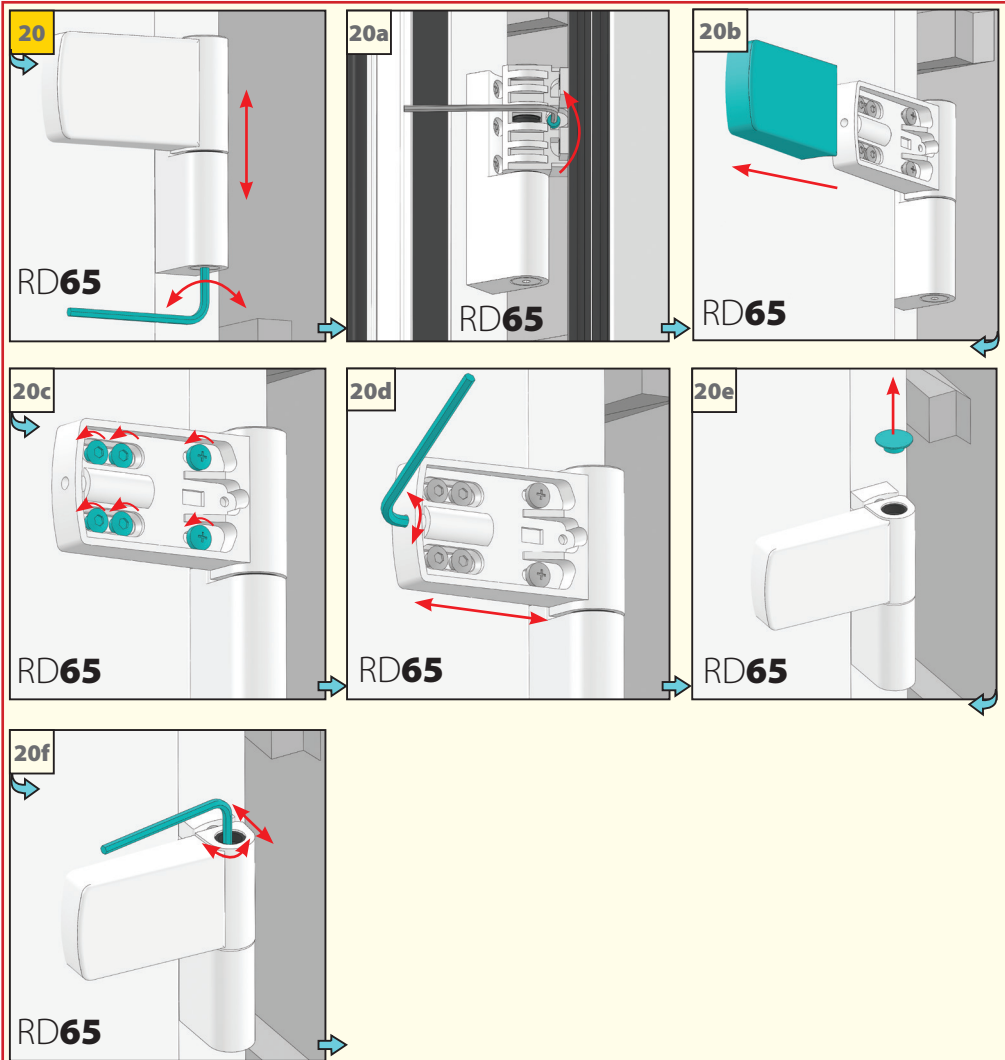

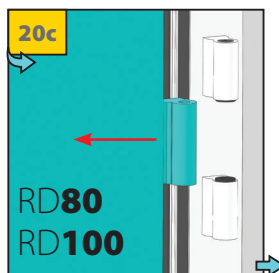
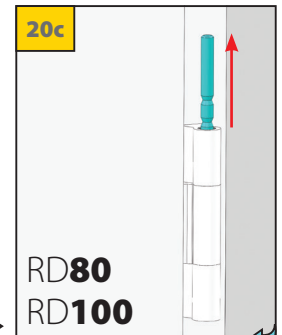
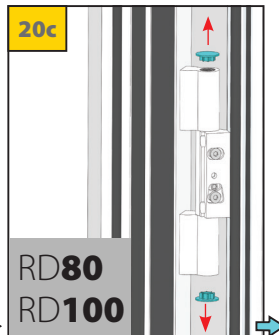
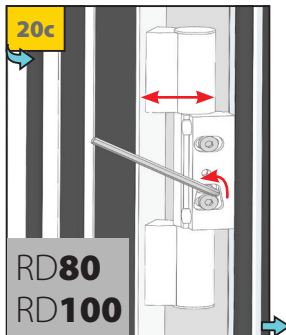
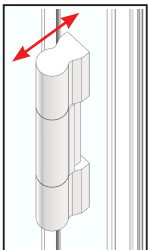
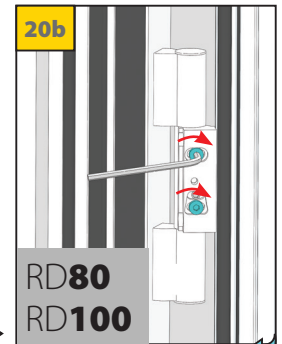
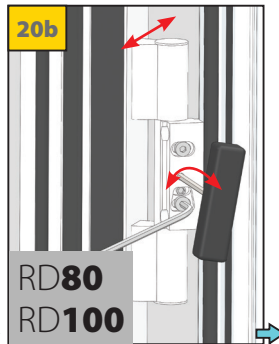
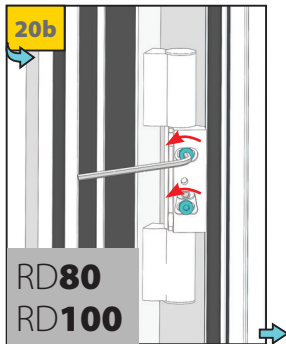
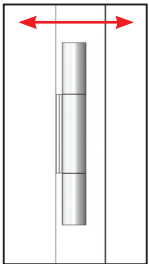
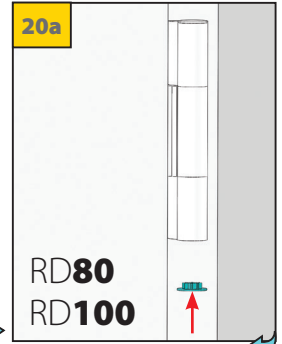
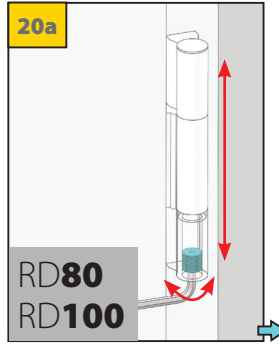
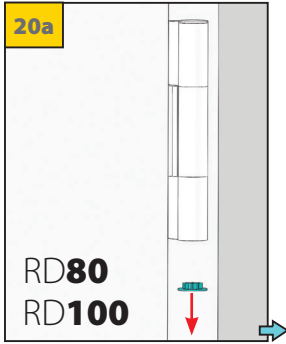
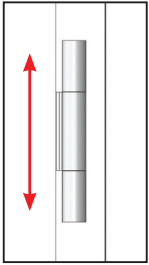

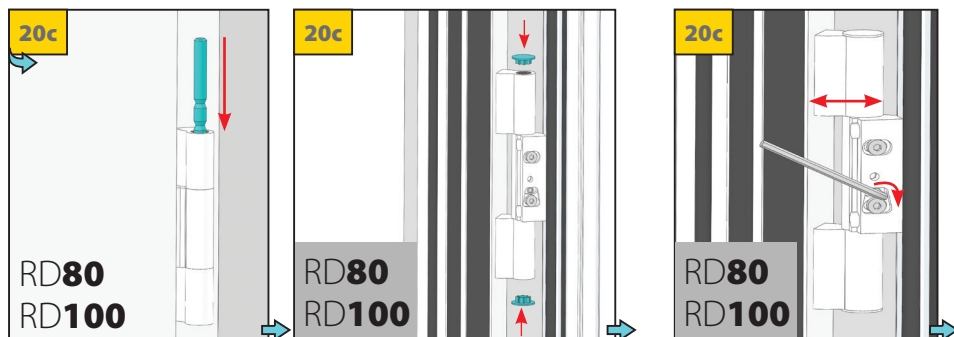
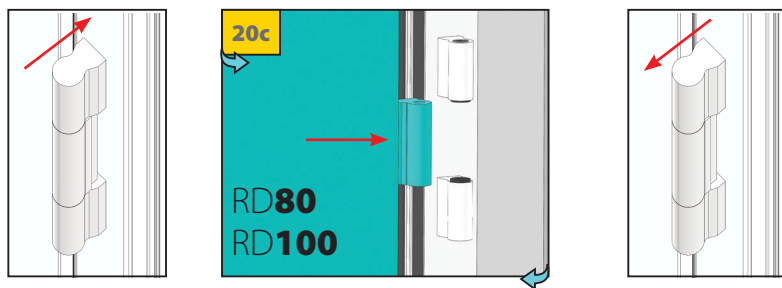
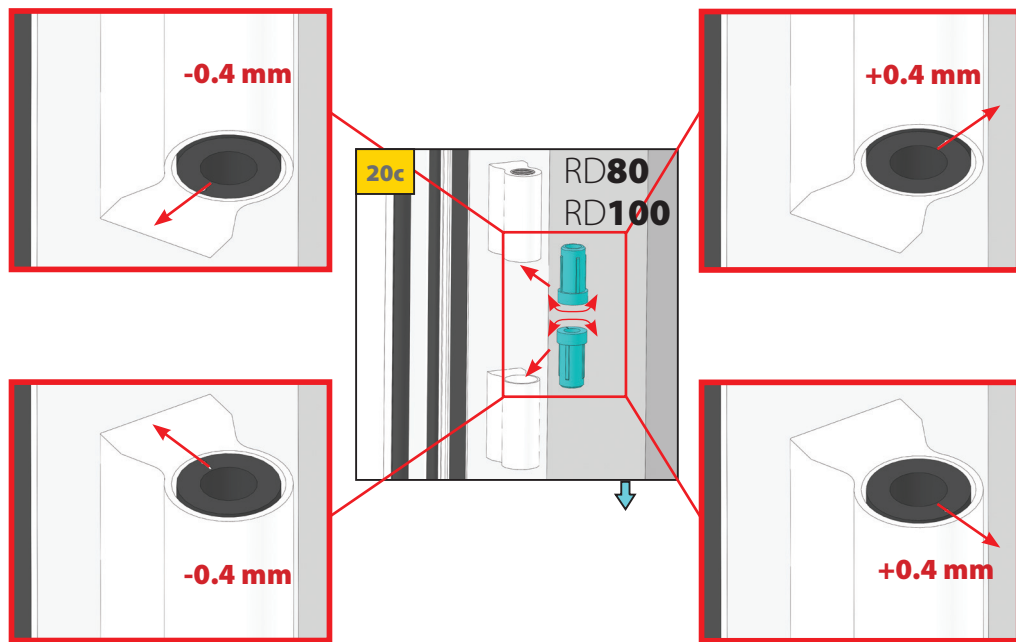

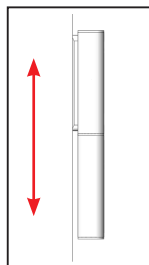

RD65N

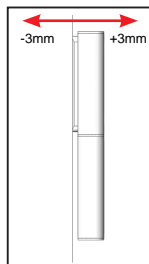

RD65N

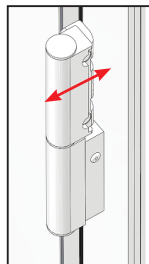



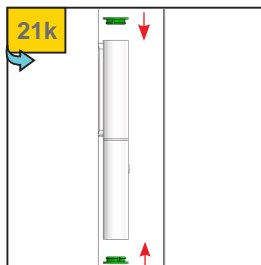
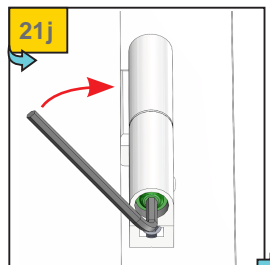
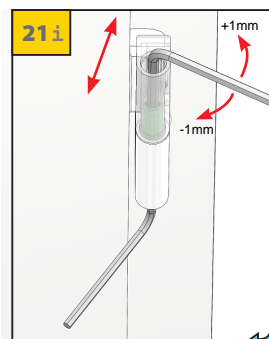
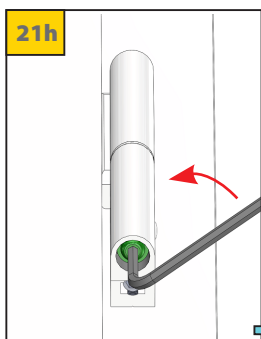
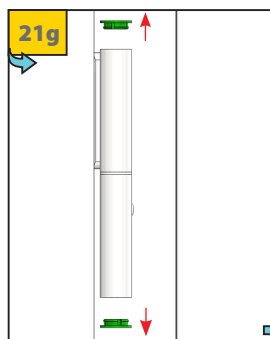
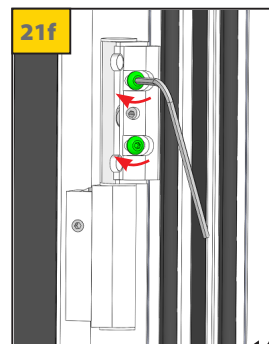
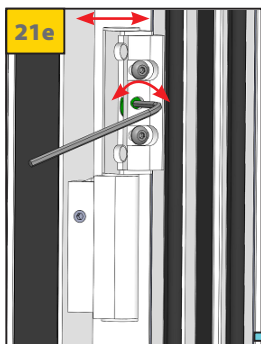
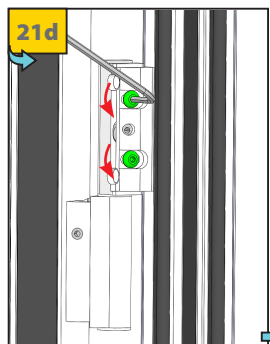
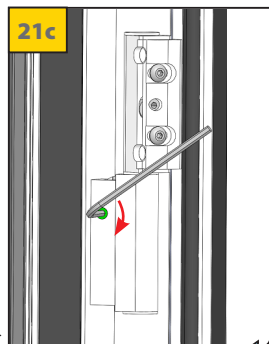
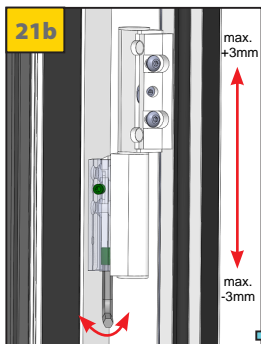
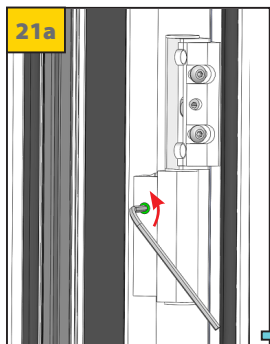

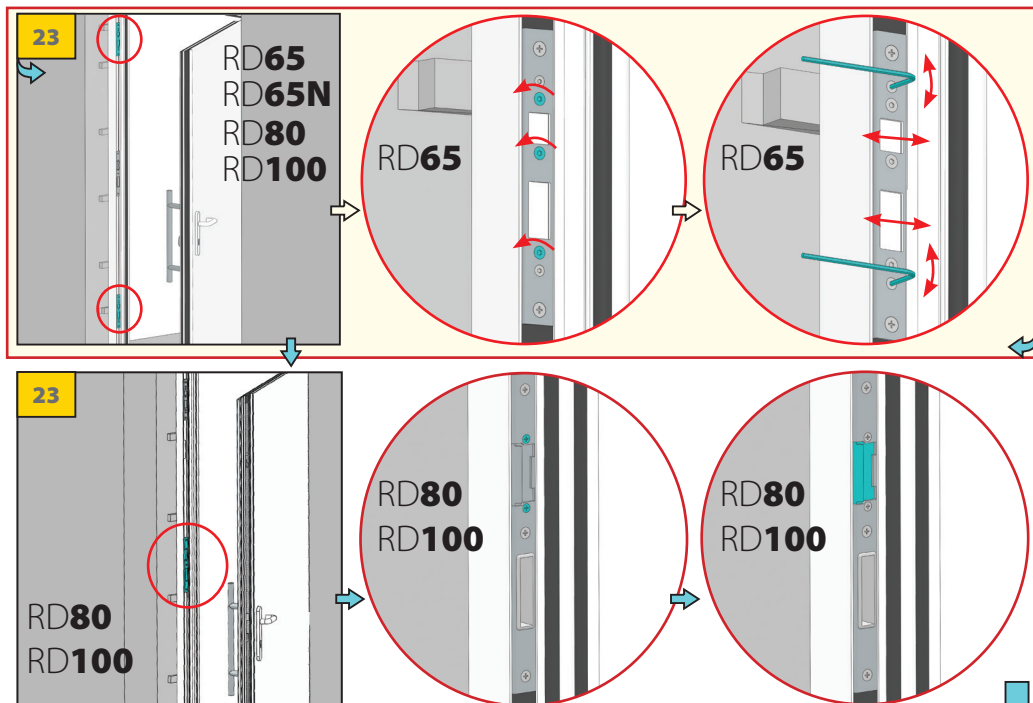

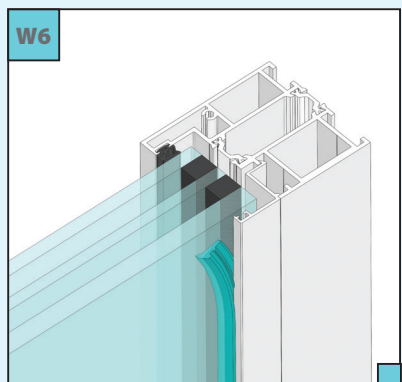
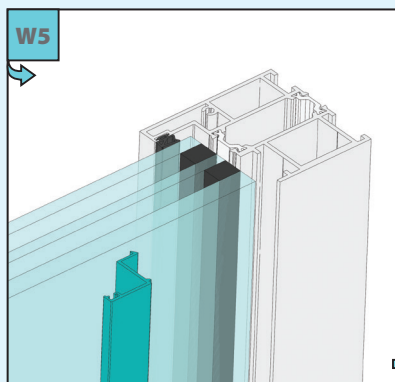
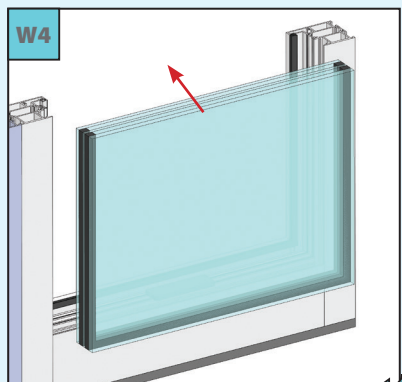
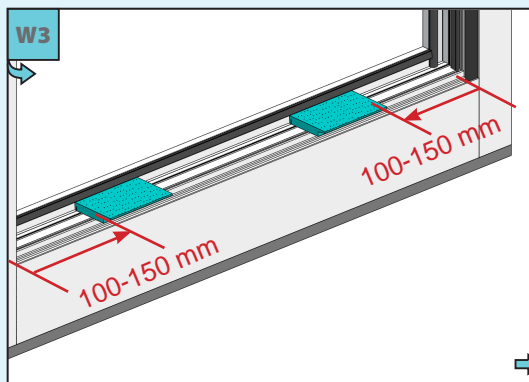
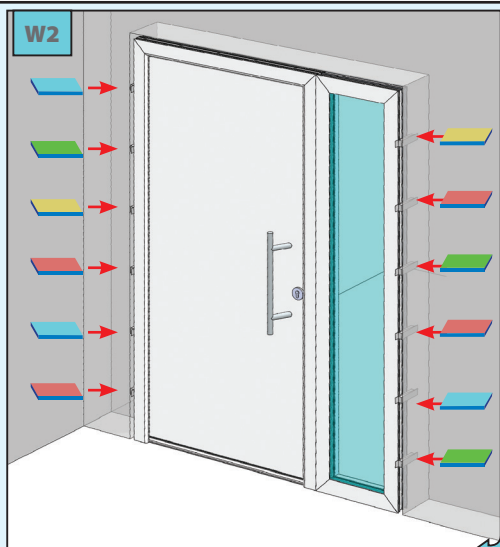
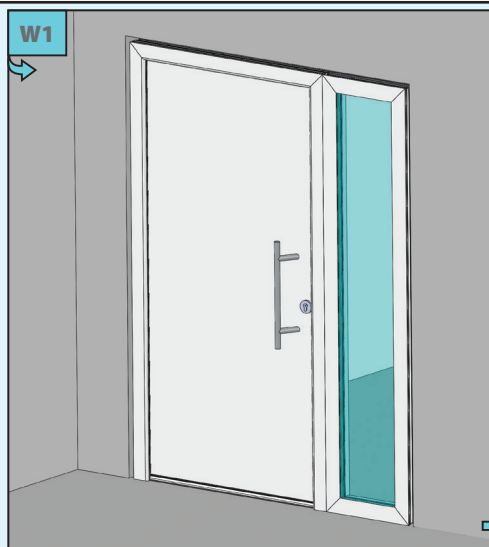
RD65N

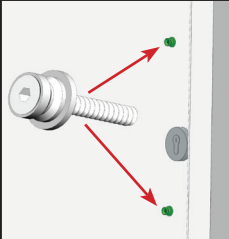

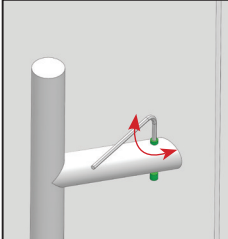

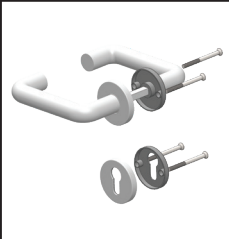
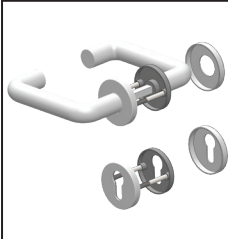
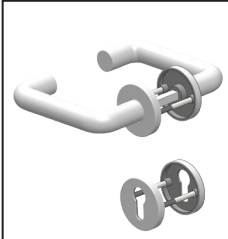
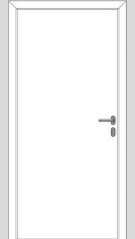
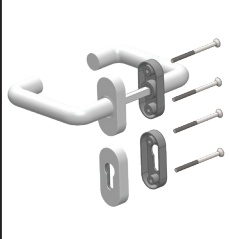
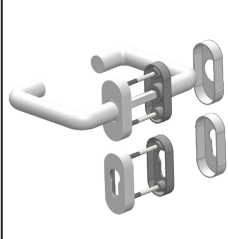
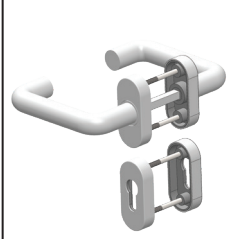

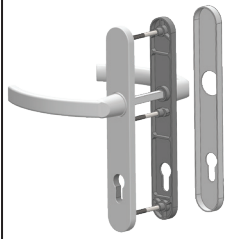
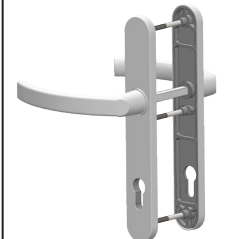
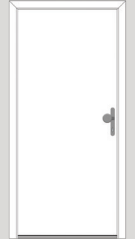
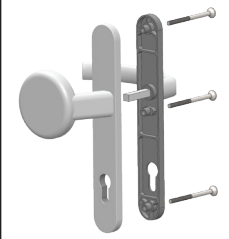
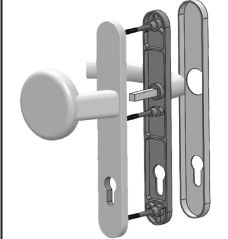
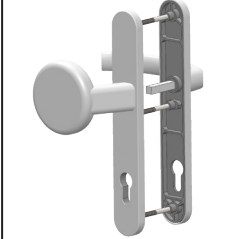
45° handle				
HLS 02-07 handle				
HLS 10-12 handle				
HL, HLA, HLS 01 handle				
HK knob handle				

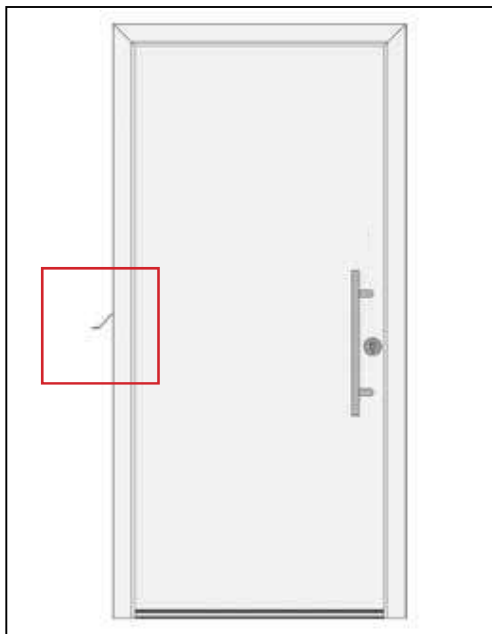

For locks:
L3P+D&N+EM
without
finger-scanner.

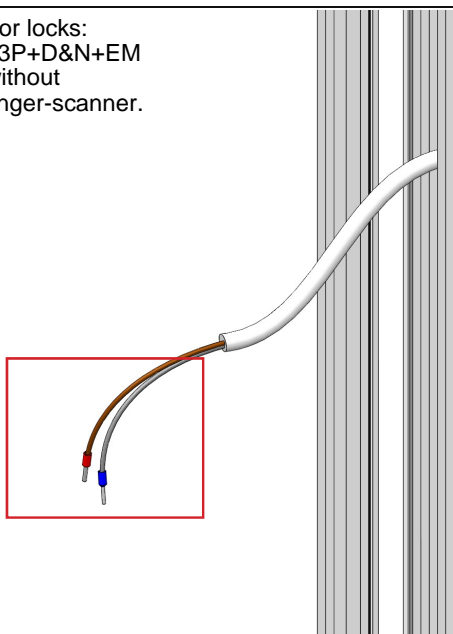

1. Brown wire
with Red head
(+) 12-24V DC min.1500 mA

2. Grey wire
with Blue head
(-) 12-24V

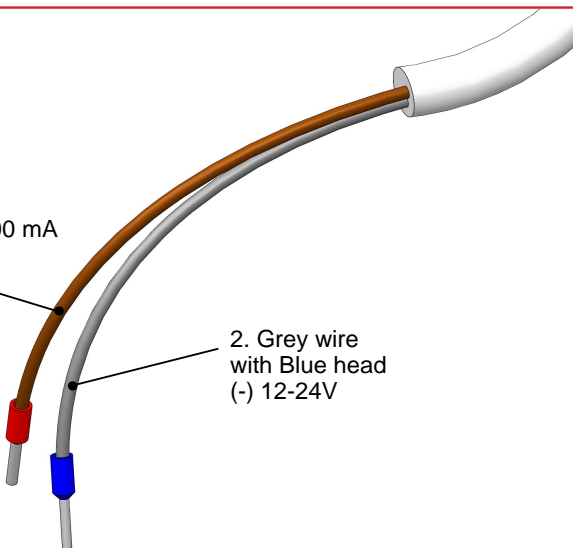

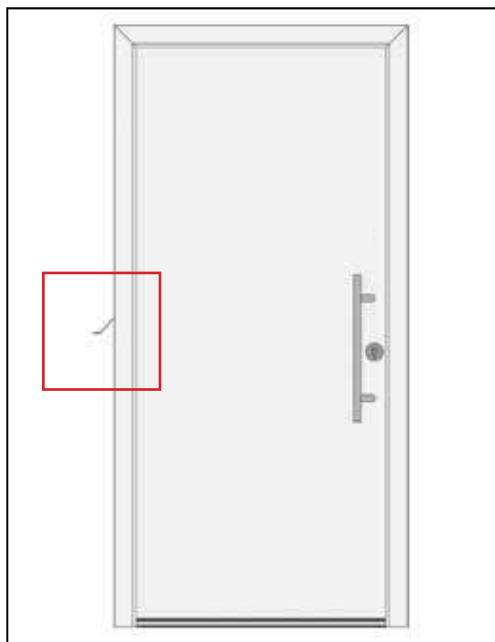

For locks:
L5PMA
L5PA
without
finger-scanner.

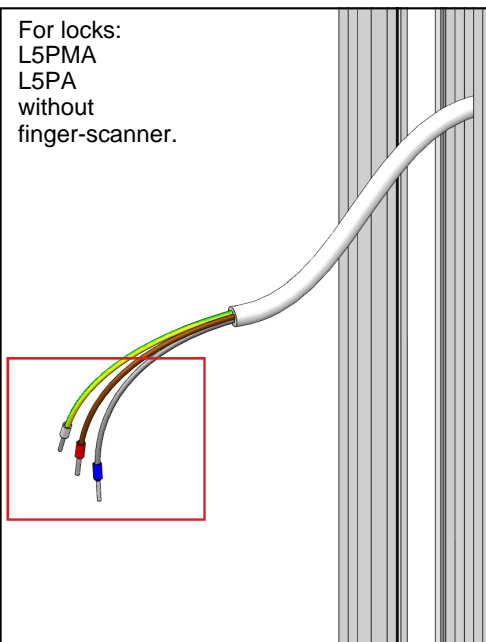

1. Yellow/Green wire
with White head
Impuls

2. Brown wire
with Red head
(+) 24V DC min.1500 mA

3. Grey wire
with Blue head
(-) 24V

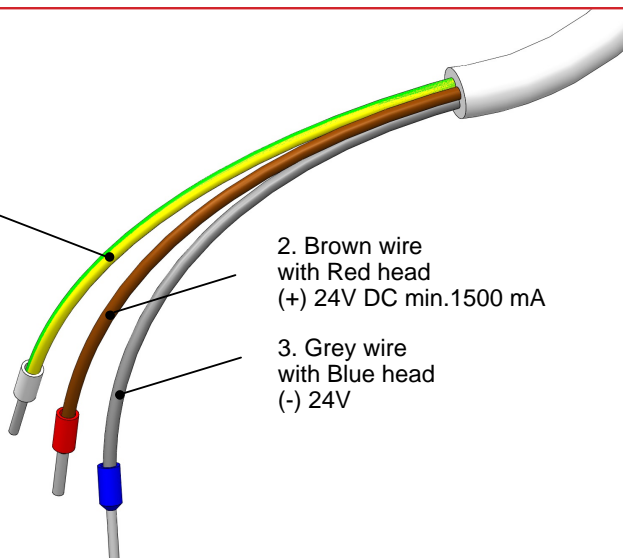

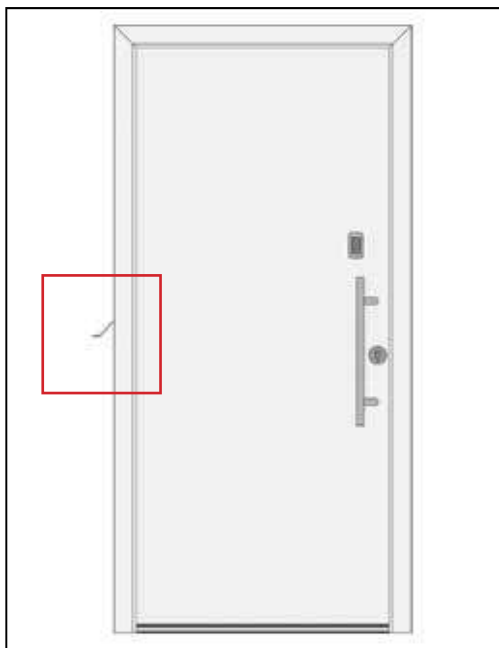

For locks:
L3P+D&N+EM
L5PMA
L5PA
connected to
finger-scanner.

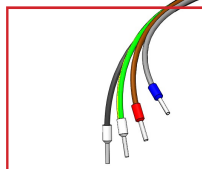

1. Black wire
with White head
To taster

2. Yellow/Green wire
with White head
To taster

3. Brown wire
with Red head
(+) 24V DC min.1500 mA

4. Grey wire
with Blue head
(-) 24V

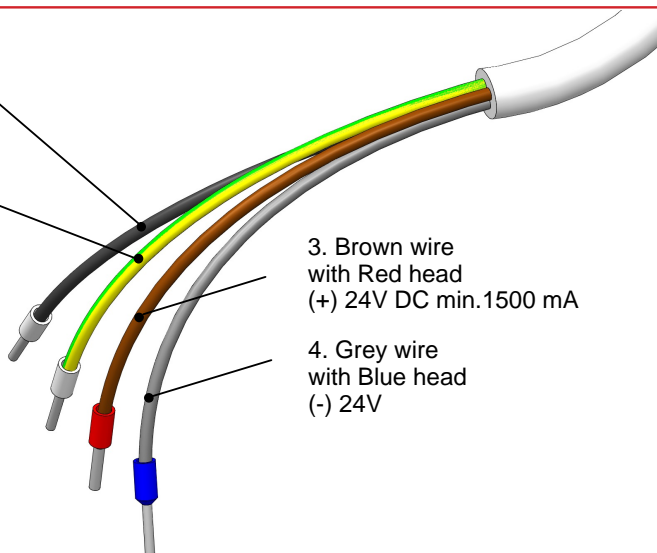

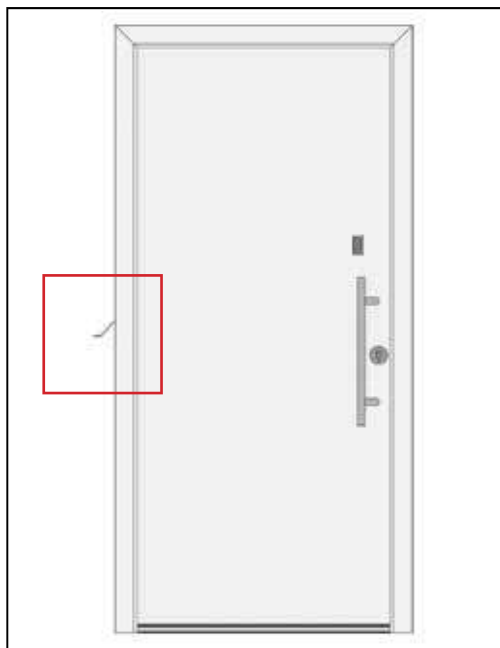

For locks:
L3P+D&N+EM
L5PMA
L5PA
connected to
ekey dLine
finger-scanner.

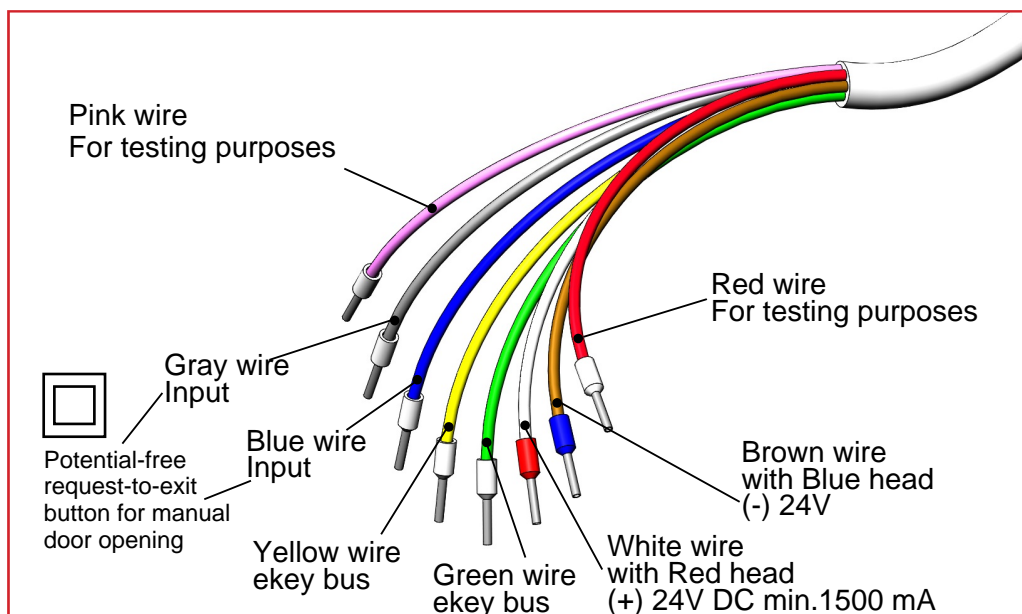
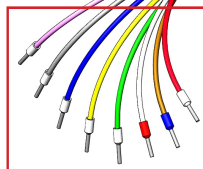



Made by RYTERNA Entry